



AXONOMETRIC VIEW

LEGEND

- Events area
- Self Binding Gravel  
eg. Cedec Red
- Coppice Tree
- Meadow Mix with  
Flowering Shrubs
- Rain Garden Meadow  
Mix with Shrubs
- Mixed Shrub and Herbaceous  
- Herbs and Medicinal.
- Mixed Shrub and Herbaceous  
- Textiles and Dyes

- 1. Events area
- 2. Auditorium Seating
- 3. Pollinator Bank
- 4. Gallery Space
- 5. Culinary and Medicinal Garden
- 6. Artist Residency Plots
- 7. Growing Workshop
- 8. Story and Culinary Workshop
- 9. Coppice and Rain Garden
- 10. Quiet Space with Log Wall / Stumpery
- 11. Existing James Grieve Apple Tree
- 12. Existing Espaliers
- 13. Main Entrance Gate
- 14. Secondary Entrance
- 15. Store and Composting

MATERIAL CHOICES

FURNITURE AND STRUCTURES



The garden will include a number of structures such as a rabbit proof entry gate, raised planters and furniture such as benches and other seating and a fire pit. These will be made of natural materials such as timber where appropriate and will reflect the material palette of the external spaces within the Barn complex.

PLANTING



Planting choices will celebrate the ecological diversity and cultural heritage of the region with planting beds devoted to educational and sensory exploration. The act of growing plants, including from seeding to maintenance and harvest is intrinsic to the artistic and cultural programme of the garden. Plants will be used as a resource for creative practice within artistic work and public workshops.

PATH NETWORK AND ACCESS



Surfaces will be chosen for environmental credentials and to compliment the existing palette used within the external spaces of the Barn's complex. The path network is composed of self binding gravel, a material with a loose crumb on the surface but bound enough to allow good access for wheelchairs etc. With an attractive finish, the material forms a firm but porous structure that retains moisture while allowing any excess to flow through.

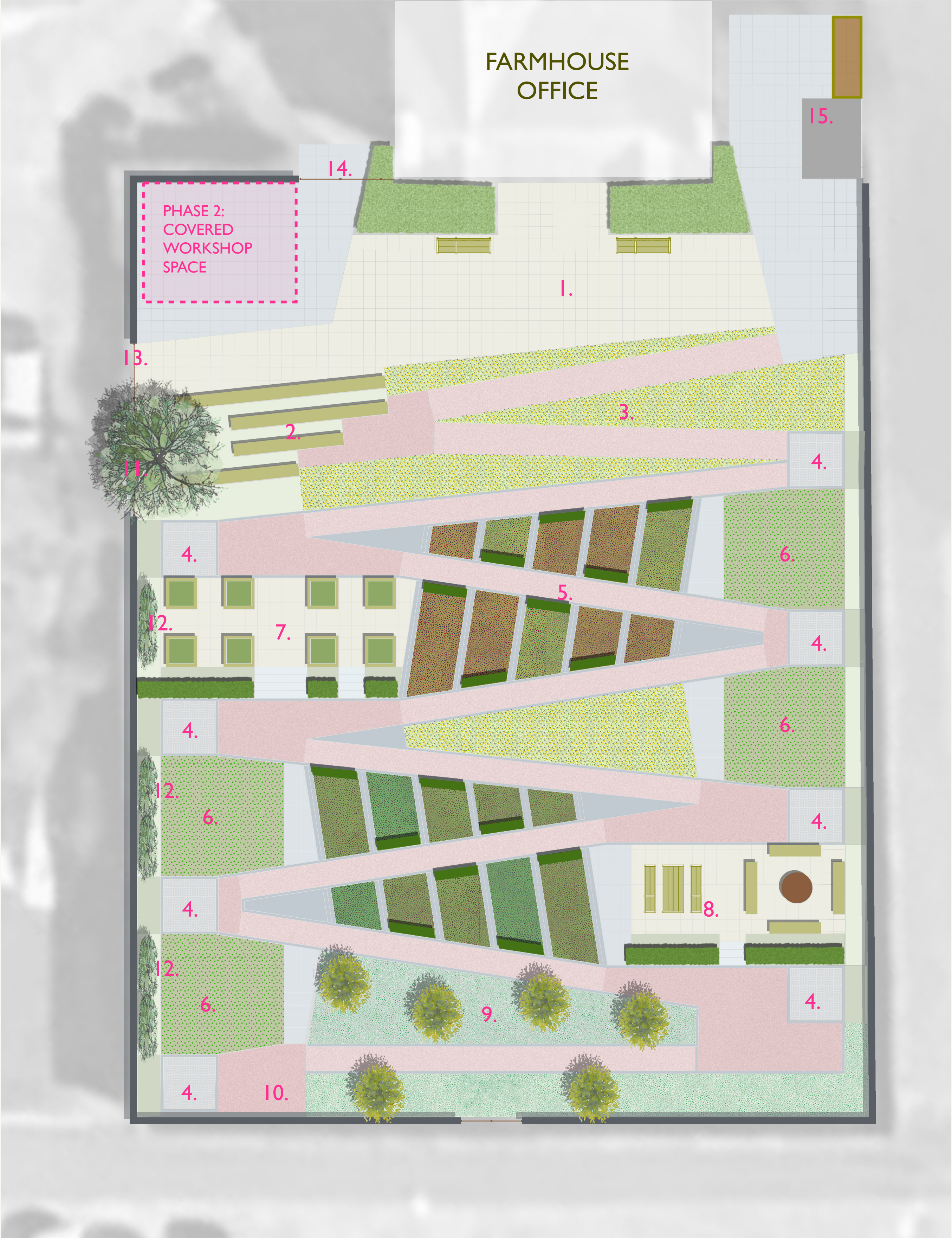

CONCEPT PLAN

0 1 2 3 4 5  
SCALE 1:100  
NORTH